

Twist Lane, Leigh, WN7 4DA
Offers Over £110,000

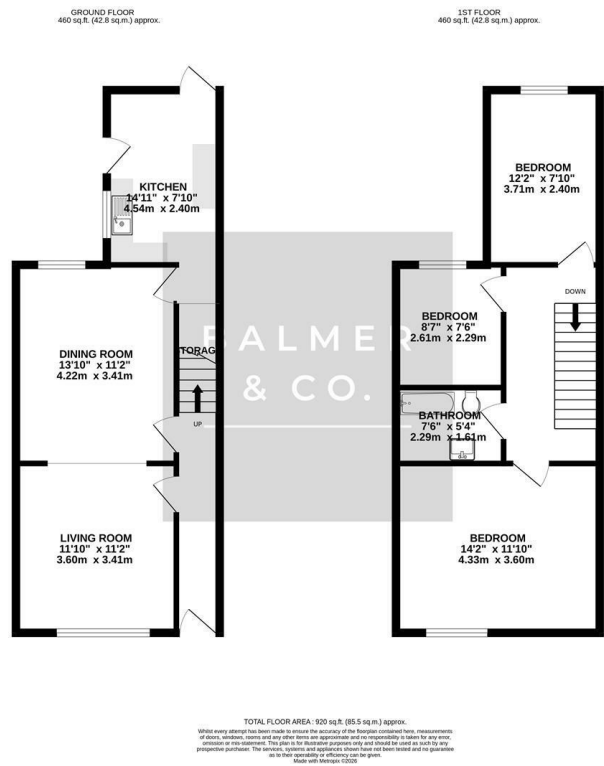

BALMER & CO in LEIGH are delighted to offer FOR SALE this three bedroom mid-terrace house situated close to Leigh town centre. Offered with NO ONWARD CHAIN this property does require modernisation but has been price accordingly. Comprising in brief of entrance hallway, living room, large dining room, with a fitted kitchen to the rear completing the ground floor. To the first floor is a large master bedroom, second double bedroom, third single bedroom, with a three piece bathroom completing the accommodation on offer. Externally the property is pavement fronted, whilst to the rear is a fully enclosed yard. Early viewings highly recommended, all enquiries welcome.

Floor Plan



Area Map

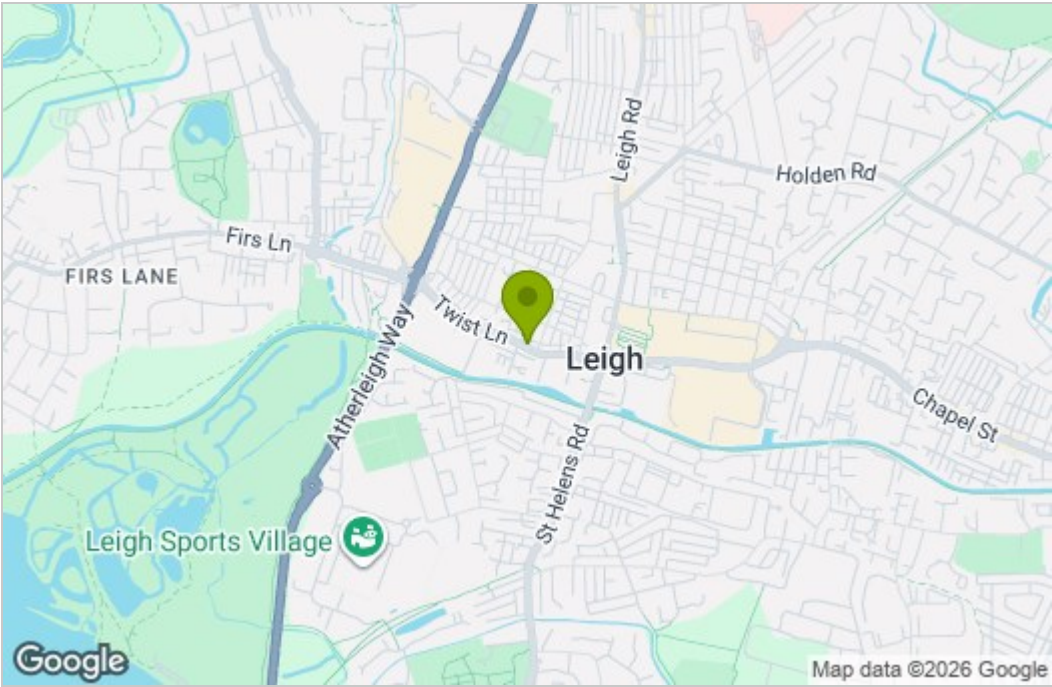

Energy Efficiency Graph

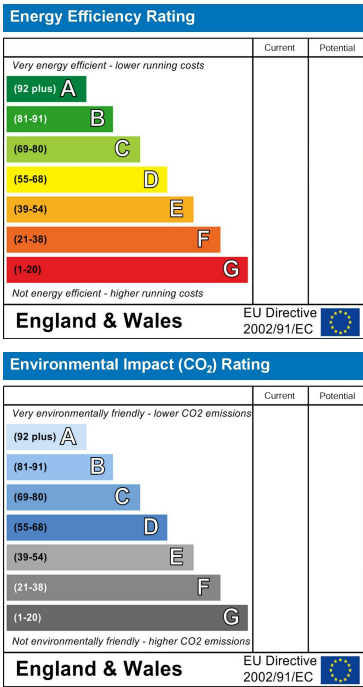

These particulars, whilst believed to be accurate are set out as a general outline only for guidance and do not constitute any part of an offer or contract. Intending purchasers should not rely on them as statements of representation of fact, but must satisfy themselves by inspection or otherwise as to their accuracy. No person in this firms employment has the authority to make or give any representation or warranty in respect of the property.